

VILLAGE OF SOMONAUK ANNEXATION AND ZONING MAP

VILLAGE OF SOMONAUK ZONING LEGEND	
	A-1 - AGRICULTURAL DISTRICT
	R-1 - SINGLE FAMILY RESIDENCE DISTRICT (8000 SQ.FT. LOT)
	R-1A - SINGLE FAMILY RESIDENCE DISTRICT (10000 SQ.FT. LOT)
	R-2 - GENERAL RESIDENCE DISTRICT
	R-3 - MULTIPLE DWELLING UNIT DISTRICT
	B-1 - GENERAL BUSINESS DISTRICT
	B-2 - COMMUNITY BUSINESS DISTRICT
	M-1 - MANUFACTURING DISTRICT
	CM - COMMERCIAL MANUFACTURING DISTRICT
	VILLAGE CORPORATE BOUNDARY
	CONDITIONAL USES

NORTHVILLE TOWNSHIP ZONING LEGEND	
	A-2 - GENERAL AGRICULTURE
	RR - RURAL RESIDENTIAL
	B-1 - LOCAL BUSINESS
	MHP - MOBILE HOME PARK
	C-1 - LOWLAND CONSERVANCY
	R-2 - LAKE HOLIDAY ZONING

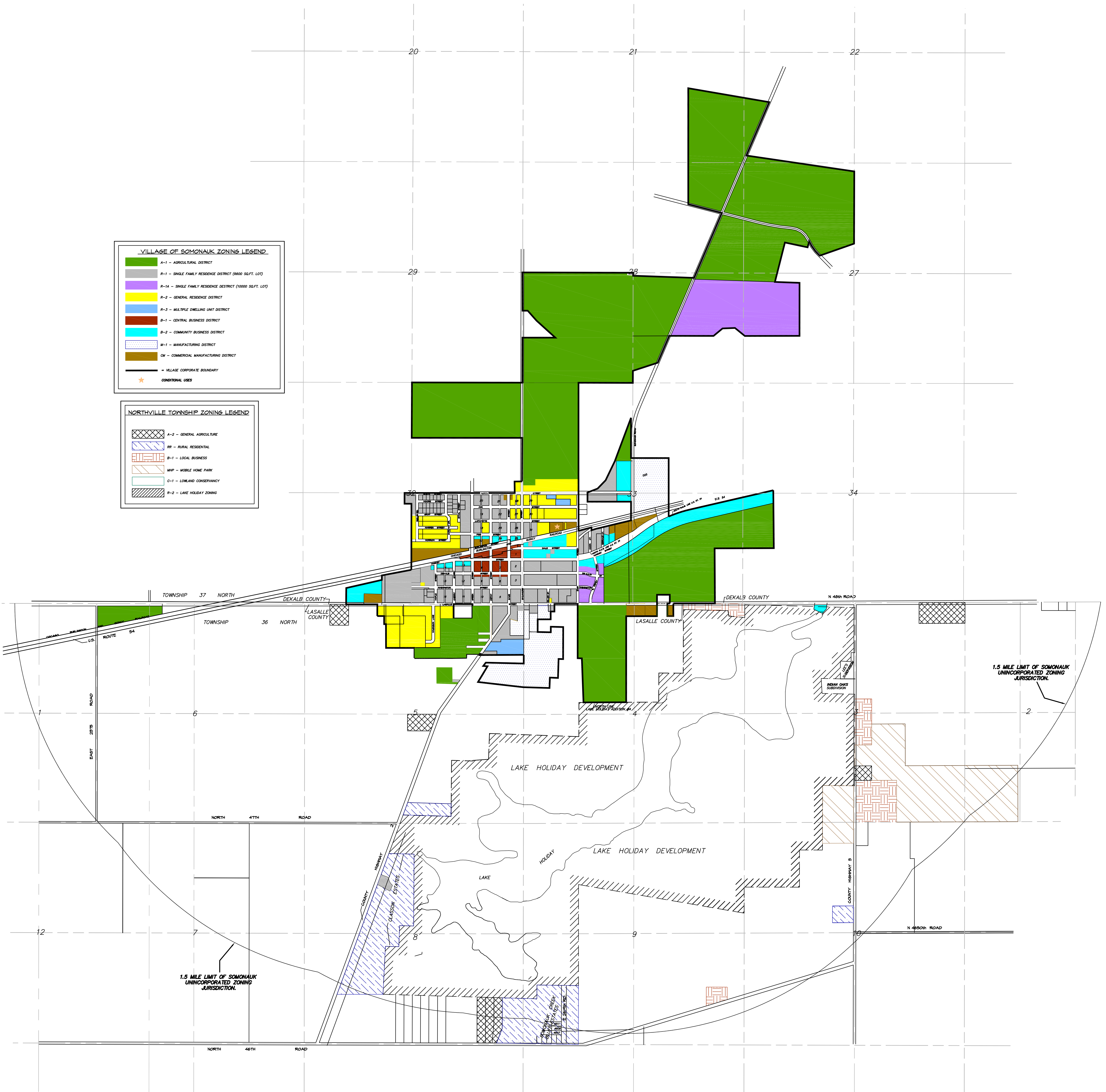

NOTES:
 * This map was created for use as a Zoning and Annexation Exhibit. This map is not to be used for any construction or staking purposes without consent from a proper agent of Smith Engineering Consultants, Inc.
 * This IS NOT a Plot of Survey. No assumptions or agreements as to ownership, use, or possession can be conveyed from this document.
 * No underground improvements have been located unless shown and noted.
 * No distance should be assumed by scaling.
 * This map is void without original embossed or red colored seal and signature affixed.
 * This map was prepared under the direction of the Village Board of Trustees of Somonauk, and was based solely upon information provided to SEC by said Board of Trustees.

VILLAGE OF SOMONAUK ANNEXATION AND ZONING MAP DEKALB AND LASALLE COUNTY, ILLINOIS			
1.	DRAWN BY:	DATE:	PROJECT NO.
2.	DESIGNED BY:	HORIZ. SCALE:	SHEET NO.
3.	CHECKED BY:	VERT. SCALE:	1
4.			
5.			

CLIENT: VILLAGE OF SOMONAUK
 DRAWN BY: CLD CHECKED BY: MH
 SCALE: 1"=800' SEC. = T. = R. =
 JOB NO.: 050152.03
 DATE: 4/20/05
 FIELD WORK COMPLETED: —
 REVISIONS: —
 ALL DISTANCES SHOWN IN FEET AND DECIMAL PARTS THEREOF